

PART NO	WIRE RANGE AWG (mm ²)	STRIP LENGTH -0 +1/32 (-0,79)	L	ID-1	OD-1	OD-2	INSTALL TOOLS
F73-5-M	24 (0,25)	7/32 (5,0)	0.20 (5,0)	0.03 (0,8)	0.04 (1,1)	0.07 (1,7)	CT-1002
F73-7-M		9/32 (7,0)	0.28 (7,0)	0.03 (0,8)	0.04 (1,1)	0.07 (1,7)	
F74-5-M	24 (0,34)	7/32 (5,0)	0.20 (5,0)	0.04 (0,9)	0.05 (1,2)	0.07 (1,8)	CT-1002
F74-7-M		9/32 (7,0)	0.28 (7,0)	0.04 (0,9)	0.05 (1,2)	0.07 (1,8)	
F75-6-M	22 (0,50)	1/4 (6,0)	0.24 (6,0)	0.04 (1,0)	0.05 (1,3)	0.08 (2,1)	CT-1002
F75-8-M		5/16 (8,0)	0.31 (8,0)	0.04 (1,0)	0.05 (1,3)	0.08 (2,1)	
F75-10-M	20 (0,75)	1/3/32 (10,0)	0.39 (10,0)	0.04 (1,0)	0.05 (1,3)	0.08 (2,1)	CT-1002
F76-6-M		1/4 (6,0)	0.24 (6,0)	0.05 (1,2)	0.06 (1,5)	0.09 (2,3)	
F76-8-M	20 (0,75)	5/16 (8,0)	0.31 (8,0)	0.05 (1,2)	0.06 (1,5)	0.09 (2,3)	CT-1003
F76-10-M		1/3/32 (10,0)	0.39 (10,0)	0.05 (1,2)	0.06 (1,5)	0.09 (2,3)	
F76-12-M	18 (1)	15/32 (12,0)	0.47 (12,0)	0.05 (1,2)	0.06 (1,5)	0.09 (2,3)	CT-1002
F77-6-M		1/4 (6,0)	0.24 (6,0)	0.06 (1,4)	0.07 (1,7)	0.10 (2,5)	
F77-7-M	18 (1)	9/32 (7,0)	0.28 (7,0)	0.06 (1,4)	0.07 (1,7)	0.10 (2,5)	CT-1003
F77-8-M		5/16 (8,0)	0.31 (8,0)	0.06 (1,4)	0.07 (1,7)	0.10 (2,5)	
F77-10-M	16 (1,50)	1/3/32 (10,0)	0.39 (10,0)	0.06 (1,4)	0.07 (1,7)	0.10 (2,5)	CT-1003
F77-12-M		15/32 (12,0)	0.47 (12,0)	0.06 (1,4)	0.07 (1,7)	0.10 (2,5)	
F78-7-M	16 (1,50)	9/32 (7,0)	0.28 (7,0)	0.07 (1,7)	0.08 (2,0)	0.11 (2,8)	CT-1003
F78-8-M		5/16 (8,0)	0.31 (8,0)	0.07 (1,7)	0.08 (2,0)	0.11 (2,8)	
F78-10-M	16 (1,50)	1/3/32 (10,0)	0.39 (10,0)	0.07 (1,7)	0.08 (2,0)	0.11 (2,8)	CT-1003
F78-12-M		15/32 (12,0)	0.47 (12,0)	0.07 (1,7)	0.08 (2,0)	0.11 (2,8)	
F78-15-M	16 (1,50)	19/32 (15,0)	0.59 (15,0)	0.07 (1,7)	0.08 (2,0)	0.11 (2,8)	CT-1003
F78-18-M		23/32 (18,0)	0.71 (18,0)	0.07 (1,7)	0.08 (2,0)	0.11 (2,8)	
F78-20-M	16 (1,50)	25/32 (20,0)	0.79 (20,0)	0.08 (2,0)	0.09 (2,3)	0.12 (3,0)	CT-1003
F78-25-M		31/32 (25,0)	0.98 (25,0)	0.08 (2,0)	0.09 (2,3)	0.12 (3,0)	

- NOTES:
1. MATERIAL - COPPER, TIN PLATED
2. DIMENSIONS IN BRACKETS ARE IN mm OR mmz
3. FOR TOLERANCING REFER TO DIN 46228 PART 1
4. PACKAGE QTY: -L=50
-C=100
-TL=250
-D=500
-M=1000

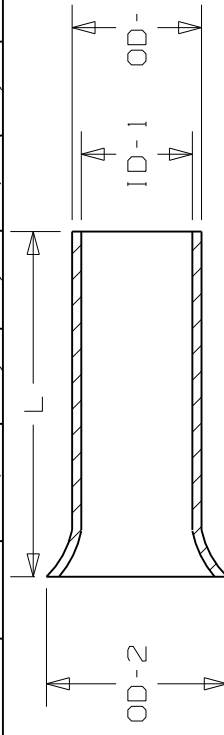

PART NO	WIRE RANGE AWG (mm ²)	STRIP LENGTH -0 +1/32 (-0,79)	L	ID-1	OD-1	OD-2	INSTALL TOOLS
F80-7-M	14 (2,50)	9/32 (7,0)	0.28 (7,0)	0.09 (2,2)	0.10 (2,5)	0.13 (3,4)	CT-1002
F80-8-M		5/16 (8,0)	0.31 (8,0)	0.09 (2,2)	0.10 (2,5)	0.13 (3,4)	
F80-10-M	14 (2,50)	1/3/32 (10,0)	0.39 (10,0)	0.09 (2,2)	0.10 (2,5)	0.13 (3,4)	CT-1002
F80-12-M		15/32 (12,0)	0.47 (12,0)	0.09 (2,2)	0.10 (2,5)	0.13 (3,4)	
F80-15-M	14 (2,50)	19/32 (15,0)	0.59 (15,0)	0.09 (2,2)	0.10 (2,5)	0.13 (3,4)	CT-1002
F80-18-M		23/32 (18,0)	0.71 (18,0)	0.09 (2,2)	0.10 (2,5)	0.13 (3,4)	
F80-20-M	12 (4)	25/32 (20,0)	0.79 (20,0)	0.09 (2,2)	0.10 (2,5)	0.13 (3,4)	CT-1003
F81-9-M		11/32 (8,0)	0.35 (9,0)	0.11 (2,8)	0.13 (3,2)	0.16 (4,0)	
F81-10-M	12 (4)	13/32 (10,0)	0.39 (10,0)	0.11 (2,8)	0.13 (3,2)	0.16 (4,0)	CT-1003
F81-12-M		15/32 (12,0)	0.47 (12,0)	0.11 (2,8)	0.13 (3,2)	0.16 (4,0)	
F81-15-M	10 (6)	19/32 (15,0)	0.59 (15,0)	0.11 (2,8)	0.13 (3,2)	0.16 (4,0)	CT-1003
F81-18-M		23/32 (18,0)	0.71 (18,0)	0.11 (2,8)	0.13 (3,2)	0.16 (4,0)	
F81-20-M	10 (6)	25/32 (20,0)	0.79 (20,0)	0.11 (2,8)	0.13 (3,2)	0.16 (4,0)	CT-1003
F82-10-M		13/32 (10,0)	0.39 (10,0)	0.14 (3,5)	0.15 (3,9)	0.19 (4,7)	
F82-12-M	10 (6)	15/32 (12,0)	0.47 (12,0)	0.14 (3,5)	0.15 (3,9)	0.19 (4,7)	CT-1003
F82-15-M		19/32 (15,0)	0.59 (15,0)	0.14 (3,5)	0.15 (3,9)	0.19 (4,7)	
F82-18-M	8 (10)	23/32 (18,0)	0.71 (18,0)	0.14 (3,5)	0.15 (3,9)	0.19 (4,7)	CT-1003
F82-20-M		25/32 (20,0)	0.79 (20,0)	0.14 (3,5)	0.15 (3,9)	0.19 (4,7)	
F83-12-D	8 (10)	15/32 (12,0)	0.47 (12,0)	0.18 (4,5)	0.19 (4,9)	0.23 (5,8)	CT-1004
F83-15-D		19/32 (15,0)	0.59 (15,0)	0.18 (4,5)	0.19 (4,9)	0.23 (5,8)	
F83-18-D	8 (10)	23/32 (18,0)	0.71 (18,0)	0.18 (4,5)	0.19 (4,9)	0.23 (5,8)	CT-1004
F83-20-D		25/32 (20,0)	0.79 (20,0)	0.18 (4,5)	0.19 (4,9)	0.23 (5,8)	
F83-25-D	8 (10)	31/32 (25,0)	0.98 (25,0)	0.18 (4,5)	0.19 (4,9)	0.23 (5,8)	CT-1004
F83-30-L		31/32 (25,0)	0.98 (25,0)	0.18 (4,5)	0.19 (4,9)	0.23 (5,8)	

PART NO	WIRE RANGE AWG (mm ²)	STRIP LENGTH -0 +1/32 (-0,79)	L	ID-1	OD-1	OD-2	INSTALL TOOLS
F84-12-TL	6 (16)	15/32 (12,0)	0.47 (12,0)	0.23 (5,8)	0.24 (6,2)	0.30 (7,5)	CT-1004
F84-15-TL		19/32 (15,0)	0.59 (15,0)	0.23 (5,8)	0.24 (6,2)	0.30 (7,5)	
F84-18-TL	6 (16)	23/32 (18,0)	0.71 (18,0)	0.23 (5,8)	0.24 (6,2)	0.30 (7,5)	CT-1004
F84-20-TL		25/32 (20,0)	0.79 (20,0)	0.23 (5,8)	0.24 (6,2)	0.30 (7,5)	
F84-25-TL	6 (16)	31/32 (25,0)	0.98 (25,0)	0.23 (5,8)	0.24 (6,2)	0.30 (7,5)	CT-1004
F84-32-TL		1 1/4 (32,0)	1.26 (32,0)	0.23 (5,8)	0.24 (6,2)	0.30 (7,5)	
F85-12-C	4 (25)	15/32 (12,0)	0.47 (12,0)	0.29 (7,3)	0.30 (7,7)	0.37 (9,5)	CT-1005
F85-15-C		19/32 (15,0)	0.59 (15,0)	0.29 (7,3)	0.30 (7,7)	0.37 (9,5)	
F85-18-C	4 (25)	23/32 (18,0)	0.71 (18,0)	0.29 (7,3)	0.30 (7,7)	0.37 (9,5)	CT-1005
F85-25-C		31/32 (25,0)	0.98 (25,0)	0.29 (7,3)	0.30 (7,7)	0.37 (9,5)	
F85-32-C	2 (35)	1 1/4 (32,0)	1.26 (32,0)	0.29 (7,3)	0.30 (7,7)	0.37 (9,5)	CT-1005
F86-18-C		23/32 (18,0)	0.71 (18,0)	0.33 (8,3)	0.34 (8,7)	0.43 (11,0)	
F86-20-C	2 (35)	25/32 (20,0)	0.79 (20,0)	0.33 (8,3)	0.34 (8,7)	0.43 (11,0)	CT-1006
F86-25-C		31/32 (25,0)	0.98 (25,0)	0.33 (8,3)	0.34 (8,7)	0.43 (11,0)	
F86-32-C	2 (35)	1 1/4 (32,0)	1.26 (32,0)	0.33 (8,3)	0.34 (8,7)	0.43 (11,0)	CT-1006
F87-18-C		23/32 (18,0)	0.71 (18,0)	0.41 (10,3)	0.43 (10,9)	0.51 (13,0)	
F87-22-C	1 (50)	7/8 (22,0)	0.87 (22,0)	0.41 (10,3)	0.43 (10,9)	0.51 (13,0)	CT-1006
F87-25-C		31/32 (25,0)	0.98 (25,0)	0.41 (10,3)	0.43 (10,9)	0.51 (13,0)	
F87-32-C	2/0 (70)	1 1/4 (32,0)	1.26 (32,0)	0.41 (10,3)	0.43 (10,9)	0.51 (13,0)	---
F89-25-L		31/32 (25,0)	0.98 (25,0)	0.49 (12,5)	0.52 (13,3)	0.59 (15,0)	
F89-32-L	2/0 (70)	1-1/4 (32,0)	1.26 (32,0)	0.49 (12,5)	0.52 (13,3)	0.59 (15,0)	---
F90-25-L		31/32 (25,0)	0.98 (25,0)	0.57 (14,5)	0.60 (15,3)	0.67 (17,0)	
F90-30-L	3/0 (95)	1-3/16 (30,0)	1.18 (30,0)	0.57 (14,5)	0.60 (15,3)	0.67 (17,0)	---
F90-32-L		1-1/4 (32,0)	1.26 (32,0)	0.57 (14,5)	0.60 (15,3)	0.67 (17,0)	

CAD FILENAME/LAYERS

A41670

PANDUIT

TINLEY PARK, ILLINOIS

FERRULE - NON-INSULATED

REV	DATE	BY	CHK	DESCRIPTION	ECN #	PM	CUST
06	4/07	BCT	BCT	MODIFIED LENGTH TO 'L'		TRO0252	LCA
05	10/04	JHNU	JHNU	ADDED 2/0 (70) AND 3/0 (95) TO TABLE.			
04	10/04	JHNU	PAB	ADDED P/N'S F89-25-L, F89-32-L, F90-25-L, F90-30-L, & F90-32-L.	12166	TPO	
03	1/01	EJS	SKB	ADDED PACKAGE CODE TO PART NUMBER ADDED NOTE 4	08912	CCH	JCJ
02	3/99	JKD	SKB	WIRE RANGE FOR CT-1003 TOOL WAS 14-8 AWG	07519	TRO	JCJ
01	3/99	JKD	SKB	WIRE RANGE WAS 22 FOR F74-5 & -7, 20 FOR F75-6, -8 & -10	07488	TRO	JCJ
00	2/99	JKD	SKB	RELEASED	07459	TRO	JCJ

UNLESS OTHERWISE SPECIFIED, DIMENSIONAL TOLERANCES ARE: (XXX) ± ANGLES ±

UNLESS OTHERWISE SPECIFIED, ALL DIMENSIONS ARE GIVEN IN INCHES, THIRD ANGLE PROJECTION

SCALE NONE

DRAWING NO. A41670

SIZE B